

FC12-7.2

FTTH Replacement Batteries 12v 7.2AH VRLA

Our FTTH series of batteries are designed as direct replacements for all FTTH Residential and Multi-Dwelling Battery Backups. This includes our solutions and other brands.



FEATURES

OUTPERFORMS PREVIOUS 8AH MODELS

12V 7.2AH VRLA

MAINTENANCE FREE

COMPATIBLE REPLACEMENT TO COMPETITOR SFU BBU'S

1 YEAR REPLACEMENT WARRANTY

5.95"L X 2.56"W X 3.94"H

F2 (.250") TERMINALS

ENVIRONMENTALLY FRIENDLY

CAN BE USED AT VERTICAL OR HORIZONTAL ORIENTATION

HIGH GAS RECOMBINATION EFFICIENCY

HIGH POWER DENSITY

ORDERING GUIDE

FC12-7.2 Precision Power FTTH Replacement Battery, 12V 8AH VRLA

SPECIFICATIONS

UL Listed

PRECISION GROUP

(888) 619-1651

Sales@GoPrecisionGroup.com

GoPrecisionGroup.com

FTTH Replacement Batteries

12v 7.2AH VRLA

DIMENSIONS & WEIGHT

Length(mm)	151±1
Width(mm)	65±1
Height(mm)	94±1
Total Height(mm)	100±1
Weight(kg)	2.13±3%

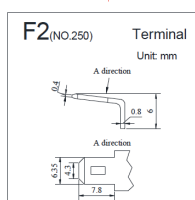
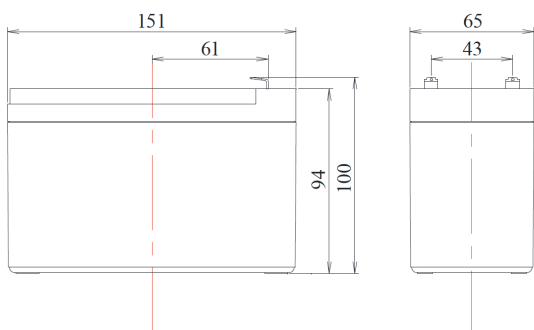

COMPLIED STANDARDS

IEC 60896-21/22	JIS C8704
YD/T799	BS6290 part4
GB/T 19639	UL 1989

SPECIFICATIONS

Nominal Voltage		12V(6 cells per unit)
Design Floating Life @25°C		5 Years
Nominal Capacity @25°C(20 hour rate@0.36A,10.50V)		7.20Ah
Capacity @25°C	10 hour rate (0.68A,10.8V)	6.80Ah
	5 hour rate (1.29A,10.5V)	6.45Ah
	1 hour rate (4.70A,9.6V)	4.70Ah
Internal Resistance	Full Charged Battery@25°C	≤22.0mΩ
Ambient Temperature	Discharge	-20°C~50°C
	Charge	-20°C~50°C
	Storage	-20°C~50°C
Max.Discharge Current@25°C		108A(5s)
Capacity affected by Temperature (10 hr Capacity)	40°C	102%
	25°C	100%
	0°C	85%
	15°C	65%
Self-Discharge@25°C per Month		3%
Charge (Constant Voltage) @25°C	Standby Use	Initial Charging Current Less than 2.16A Voltage 13.6-13.8V
	Cycle Use	Initial Charging Current Less than 2.16A Voltage 14.4-14.9V

BATTERY DISCHARGE TABLE

Discharge Constant Current Per Cell (Amperes At 25°C)

F.V/Time	5min	10min	15min	30min	45min	1h	2h	3h	5h	8h	10h	20h
1.60V	28.74	18.84	153.83	8.21	5.99	4.70	2.97	2.04	1.36	0.91	0.72	0.381
1.67V	27.38	18.06	13.54	8.07	5.89	4.55	2.92	2.00	1.34	0.89	0.71	0.373
1.70V	26.23	17.07	13.35	7.97	5.82	4.40	2.86	1.96	1.31	0.88	0.70	0.367
1.75V	25.00	16.28	12.64	7.70	5.66	4.27	2.81	1.92	1.29	0.87	0.69	0.360
1.80V	23.08	15.17	11.80	7.40	5.48	4.15	2.71	1.85	1.23	0.84	0.68	0.356

Note: The above data are average values, and can be obtained within 3 charge/discharge cycles. These are not minimum values. Cell and battery designs/specifications are subject to modification without notice.

FTTH Replacement Batteries 12v 7.2AH VRLA

BATTERY DISCHARGE TABLE CONTINUED

Discharge Constant Power per Cell (Watts at 25°C)

F.V/Time	5min	10min	15min	30min	45min	1h	2h	3h	5h	8h	10h	20h
1.60V	53.52	36.16	26.74	15.97	11.68	9.25	5.83	4.02	2.69	1.82	1.44	0.759
1.67V	51.28	34.70	26.23	15.75	11.53	8.93	5.73	3.94	2.64	1.79	1.43	0.748
1.70V	49.18	32.82	25.93	15.57	11.42	8.61	5.62	3.87	2.60	1.76	1.42	0.739
1.75V	47.11	31.34	24.60	15.10	11.14	8.29	5.52	3.80	2.54	1.75	1.40	0.723
1.80V	43.92	29.31	23.00	14.54	10.80	7.97	5.30	3.65	2.45	1.70	1.38	0.720

Note: The above data are average values, and can be obtained within 3 charge/discharge cycles. These are not minimum values. Cell and battery designs/specifications are subject to modification without notice.

PERFORMANCE CHARACTERISTICS

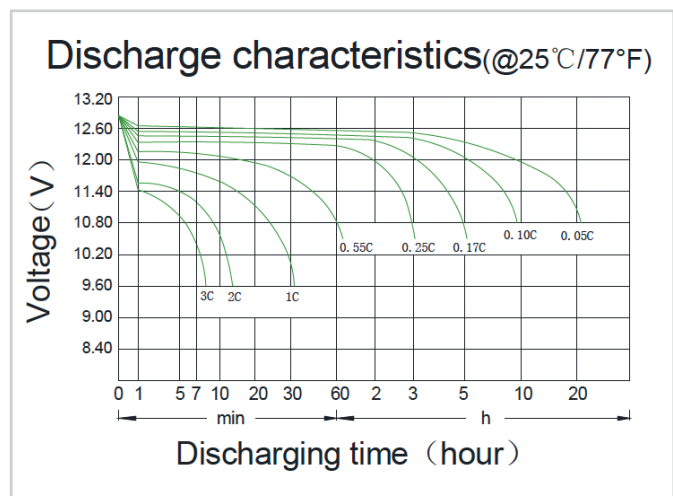
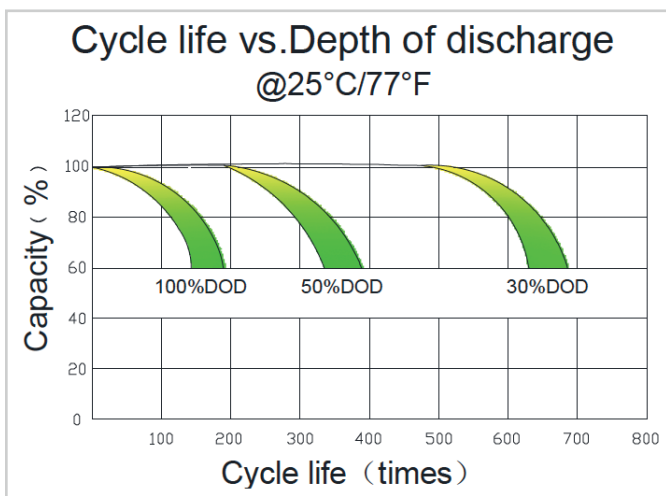
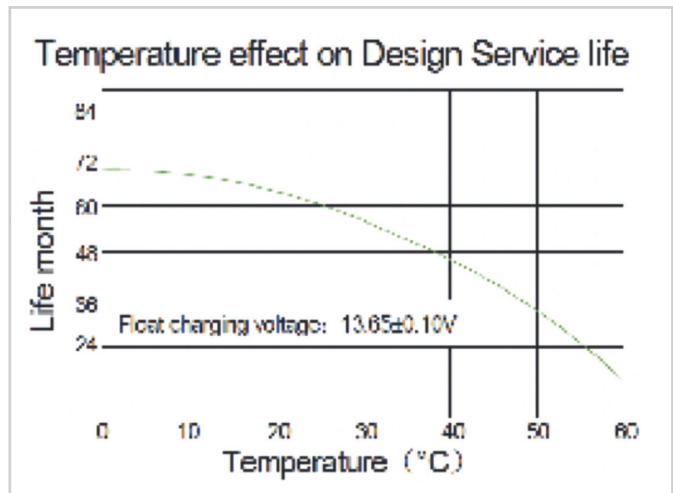
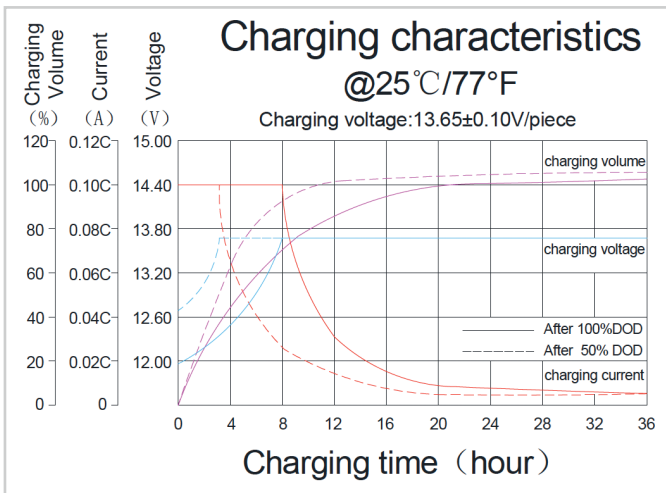

FTTH Replacement Batteries 12v 7.2AH VRLA

PERFORMANCE CHARACTERISTICS CONTINUED

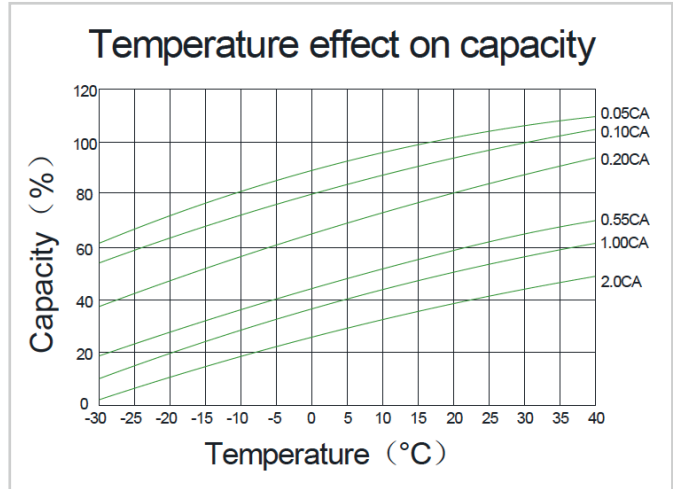
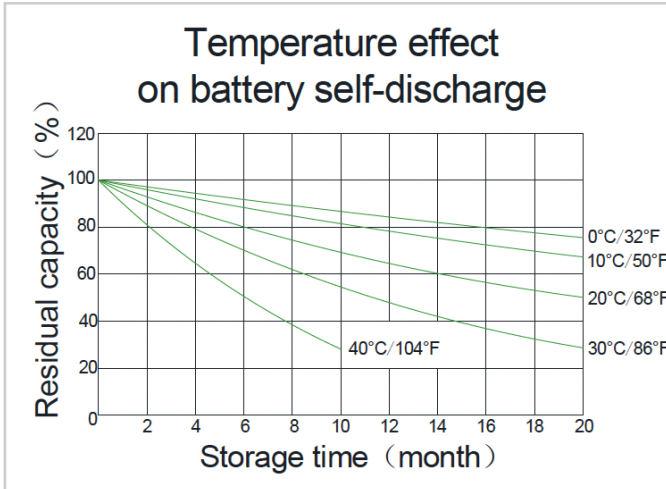

BATTERY CONSTRUCTION

Component	Positive Plate	Negative Plate	Container & Cover	Safety valve	Terminal	Separator	Electrolyte	Pillar seal
Features	Thick high Sn low Ca grid with special paste	Balanced Pb-Ca grid for improved recombination efficiency	ABS (UL94-V0 optional)	Flame Si-Rubber and aging resister	Female Copper Insert (F1/F2)	Advanced AGM separator for high pressure cell design	Dilute high purity sulphuric acid	Two layers epoxy resin seal